

Robt Young.

D20-97

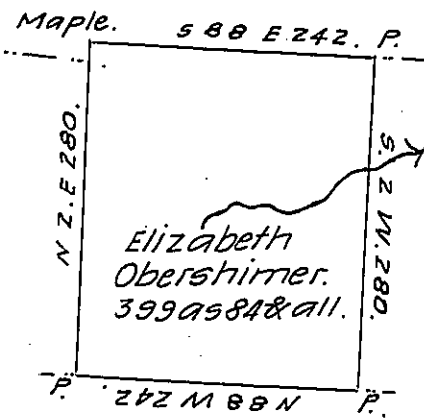

Cath^e Obersthirmer

Page 17

Wm P. Sharpless.

Draft of a tract of land, situate in the township of Wilkesbarre in Luzerne County, adjoining lands of Catharine Obersthirmer & others. Containing three hundred ninety nine acres and Eighty four perches of land, besides the usual allowance of 6 pr. Ct. for roads &c. Surveyed for Elizabeth Obersthirmer forty or forty one years ago as appears by blocking the line trees upon the ground. And resurveyed the 9th day of May A^o Dⁱ 1839 by virtue of her warrant dated the 8th day of January 1793.

Z. H. Stevens, D.S. for

To Jacob Gallade Esq^r

Luzerne County

Surveyor Gen^l

Approved and Certified by me this 17 Jan^y 1840.

Henry Colt D.S.

IN TESTIMONY that the above is a copy of the original remaining on file in the Department of Internal Affairs of Pennsylvania, made conformably to an Act of Assembly approved the 16th day of February, 1833, I have hereunto set my Hand and caused the Seal of said Department to be affixed at Harrisburg, this twentieth day of June 1906.

Jacob D. Brown
Secretary of Internal Affairs.